

प्लॉन - २

दस्तावेज-688/2018

59-160

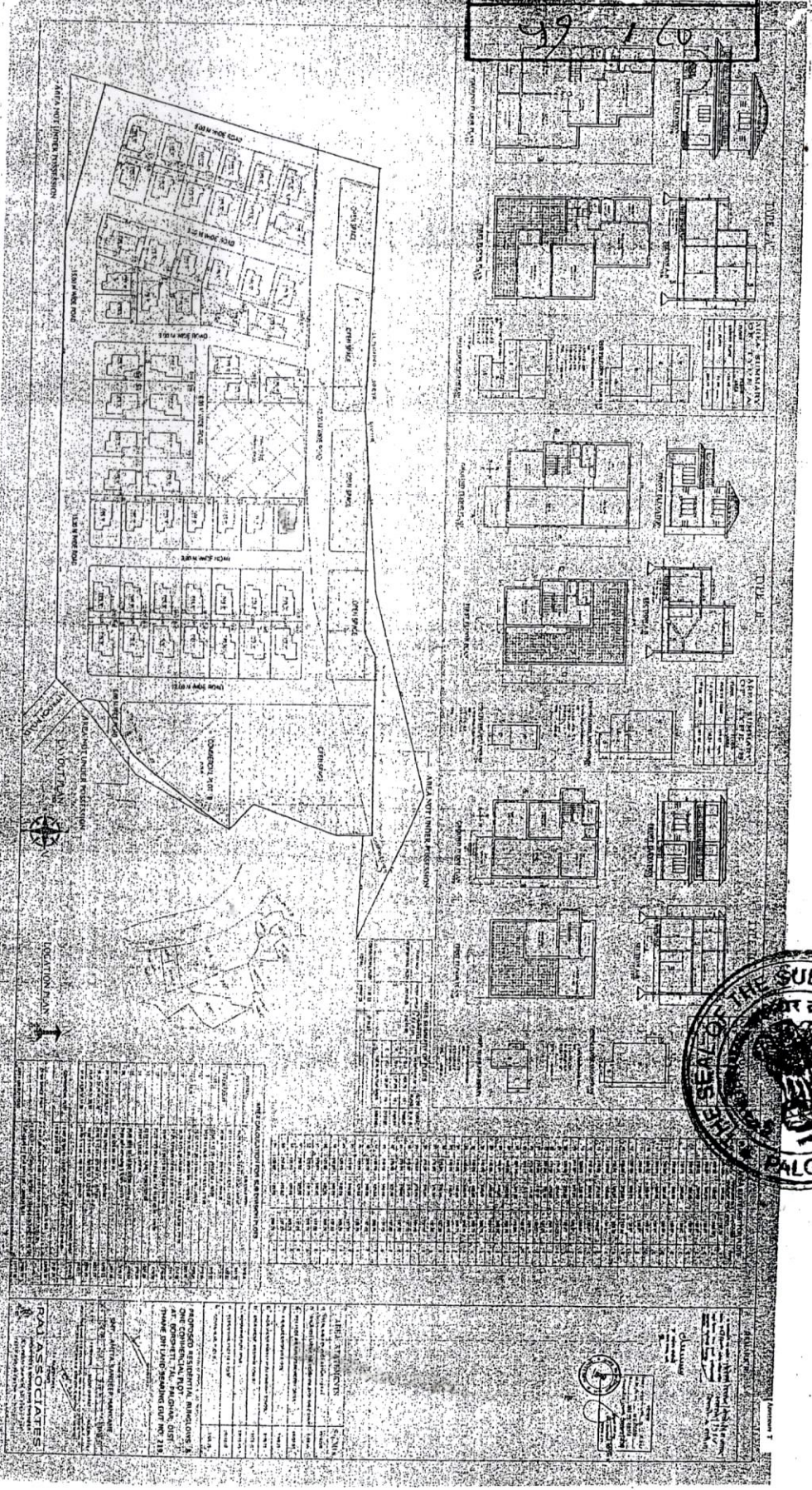

PAI ASSOCIATES
 PLOT NO. 1, 2, 3, 4, 5, 6, 7, 8, 9, 10, 11, 12, 13, 14, 15, 16, 17, 18, 19, 20, 21, 22, 23, 24, 25, 26, 27, 28, 29, 30, 31, 32, 33, 34, 35, 36, 37, 38, 39, 40, 41, 42, 43, 44, 45, 46, 47, 48, 49, 50, 51, 52, 53, 54, 55, 56, 57, 58, 59, 60, 61, 62, 63, 64, 65, 66, 67, 68, 69, 70, 71, 72, 73, 74, 75, 76, 77, 78, 79, 80, 81, 82, 83, 84, 85, 86, 87, 88, 89, 90, 91, 92, 93, 94, 95, 96, 97, 98, 99, 100

FIELD STATEMENTS
 THIS STATEMENT IS A TRUE AND CORRECT STATEMENT OF THE FACTS AND CIRCUMSTANCES AS STATED BY THE REGISTRAR AND THE SUB-REGISTRAR AND THE OFFICIALS CONCERNED THEREIN.

DECLARATION
 I, the undersigned, being a duly qualified and authorized officer of the Government of Maharashtra, do hereby declare that the above-mentioned facts and circumstances are true and correct as stated by the registrars and the officials concerned therein.

पलघर - २
 दस्तावेज क्र. ६४४/२०१४
 ५३ / ६०

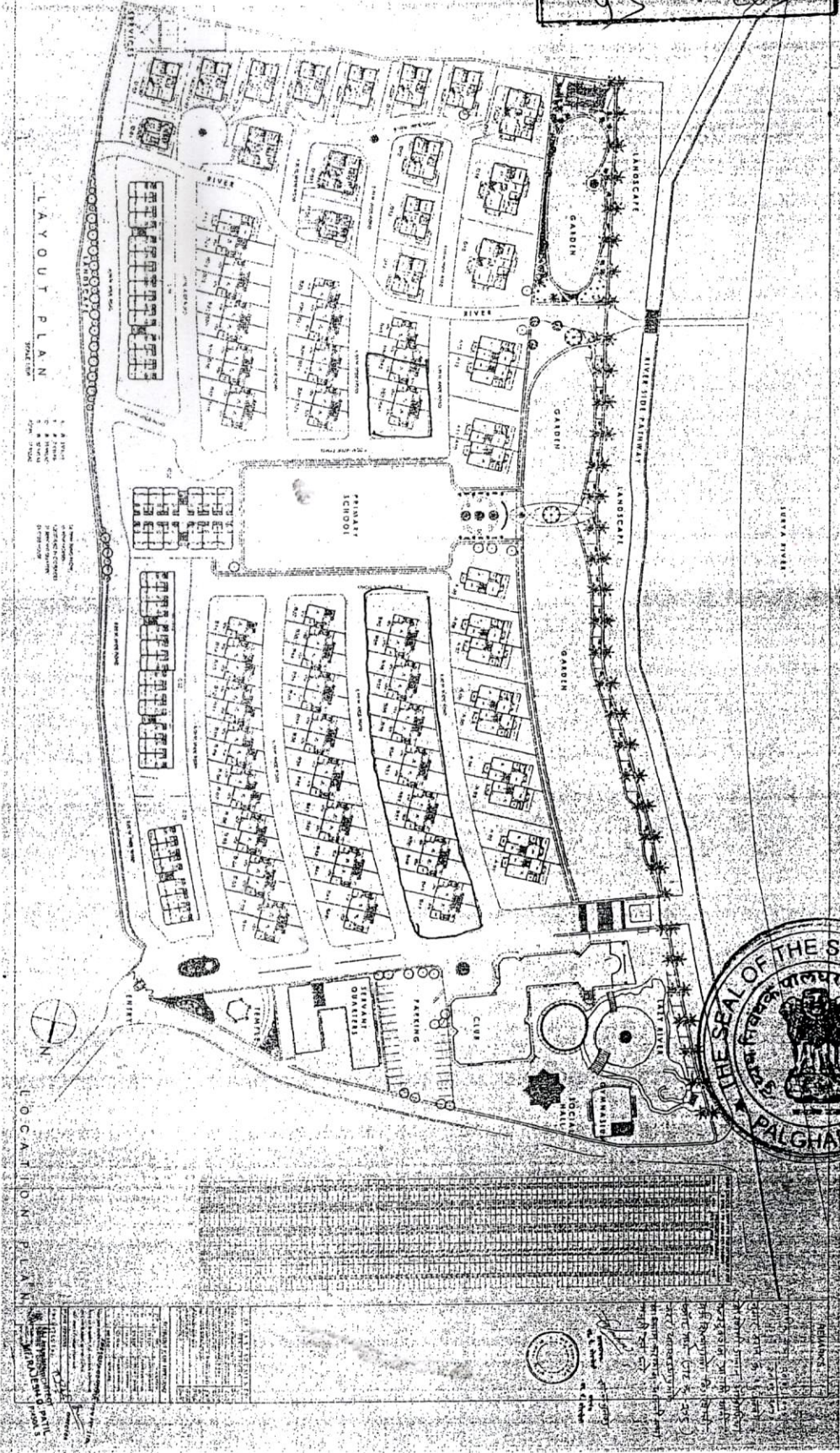

<p>1. TO BE FURNISHED TO THE REGISTRAR</p> <p>2. TO BE FURNISHED TO THE REGISTRAR</p> <p>3. TO BE FURNISHED TO THE REGISTRAR</p> <p>4. TO BE FURNISHED TO THE REGISTRAR</p> <p>5. TO BE FURNISHED TO THE REGISTRAR</p> <p>6. TO BE FURNISHED TO THE REGISTRAR</p> <p>7. TO BE FURNISHED TO THE REGISTRAR</p> <p>8. TO BE FURNISHED TO THE REGISTRAR</p> <p>9. TO BE FURNISHED TO THE REGISTRAR</p> <p>10. TO BE FURNISHED TO THE REGISTRAR</p>	<p>11. TO BE FURNISHED TO THE REGISTRAR</p> <p>12. TO BE FURNISHED TO THE REGISTRAR</p> <p>13. TO BE FURNISHED TO THE REGISTRAR</p> <p>14. TO BE FURNISHED TO THE REGISTRAR</p> <p>15. TO BE FURNISHED TO THE REGISTRAR</p> <p>16. TO BE FURNISHED TO THE REGISTRAR</p> <p>17. TO BE FURNISHED TO THE REGISTRAR</p> <p>18. TO BE FURNISHED TO THE REGISTRAR</p> <p>19. TO BE FURNISHED TO THE REGISTRAR</p> <p>20. TO BE FURNISHED TO THE REGISTRAR</p>
--	---

प्लॉट - २
 ६४४/२०१४
 ५५ - १७०

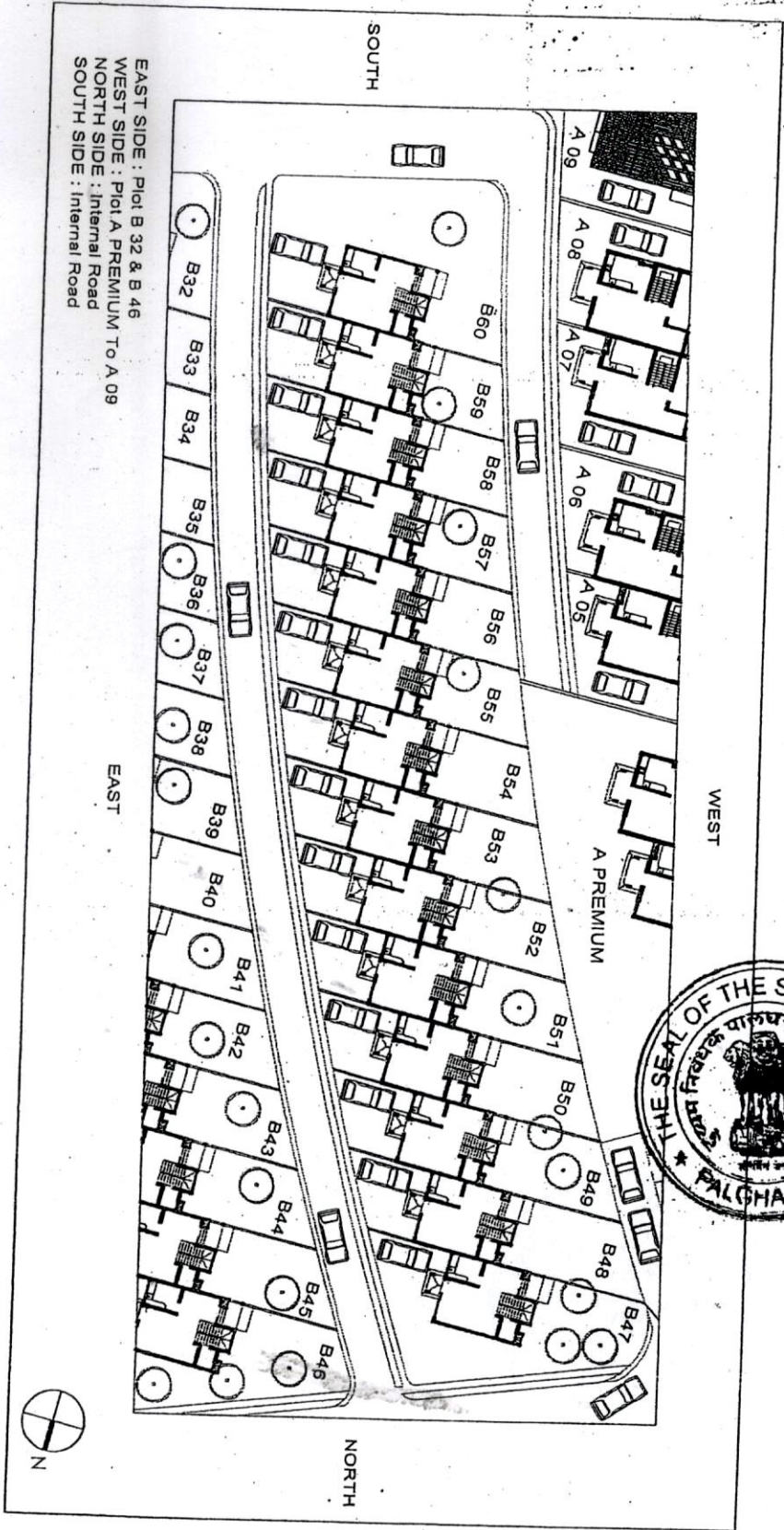

EAST SIDE : Plot B 32 & B 46
 WEST SIDE : Plot A PREMIUM To A 09
 NORTH SIDE : Internal Road
 SOUTH SIDE : Internal Road



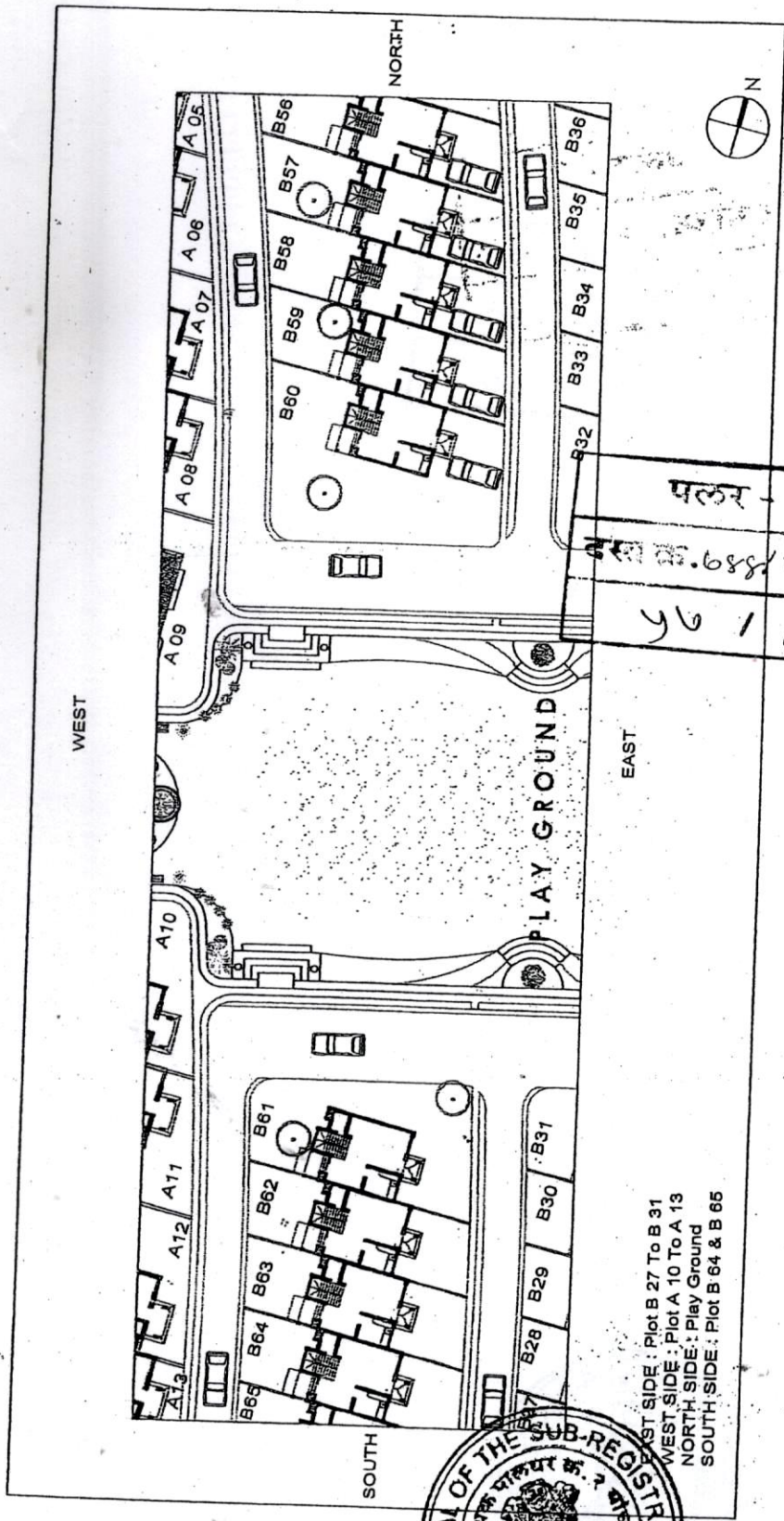

प्लॉट - २
 दरम. क्र. ६४४/२०१४
 ५० / ६०

EAST SIDE : Plot B 27 To B 31
 WEST SIDE : Plot A 10 To A 13
 NORTH SIDE : Play Ground
 SOUTH SIDE : Plot B 64 & B 65

